

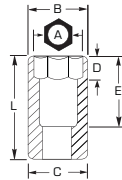

## 3/8" DRIVE DEEP SOCKETS

► Proto® Sockets are ideal for use on stubborn or damaged fasteners, and also on fasteners made from soft materials.



- Radius-corner socket design
- Engages flats for better grip
- Improves the ability to turn worn or rounded fasteners

INCH	6	12	12	Nut End Outside Diameter (in) (B)	Drive End Outside Diameter (in) (C)	Nut Depth (in) (D)	Bolt Clearance Depth (in) (E)	Overall Length (in) (L)	Weight (lbs)
1/4	J5008H	J5008	-	13/32	21/32	5/16	1-11/16	2-1/8	0.10
5/16	J5010H	J5010	-	15/32	21/32	13/32	1-11/16	2-1/8	0.10
11/32	J5011H	J5011	-	1/2	21/32	25/64	1-11/16	2-1/8	0.09
3/8	J5012H	J5012	J5012B	35/64	21/32	13/32	1-11/16	2-1/8	0.10
7/16	J5014H	J5014	J5014B	21/32	21/32	7/16	1-11/16	2-1/8	0.12
1/2	J5016H	J5016	J5016B	23/32	23/32	33/64	1-11/16	2-1/8	0.14
9/16	J5018H	J5018	J5018B	51/64	51/64	19/32	1-11/16	2-1/8	0.18
5/8	J5020H	J5020	J5020B	7/8	7/8	43/64	2-5/16	2-3/4	0.24
11/16	J5022H	J5022	J5022B	15/16	15/16	43/64	2-5/16	2-3/4	0.30
3/4	J5024H	J5024	J5024B	1-1/64	1-1/64	43/64	2-5/16	2-3/4	0.33
13/16	J5026H	J5026	J5026B	1-5/64	1-5/64	43/64	2-5/16	2-3/4	0.36
7/8	J5028H	J5028	J5028B	1-15/64	1-15/64	1-3/16	2-5/16	2-3/4	0.43
15/16	J5030H	J5030	J5030B	1-15/64	1-15/64	1-3/16	2-5/16	2-3/4	0.46
1	J5032H	J5032	J5032B	1-5/16	1-5/16	1-3/16	2-5/16	2-3/4	0.54

MM	6	12	Nut End Outside Diameter (in) (B)	Drive End Outside Diameter (in) (C)	Nut Depth (in) (D)	Bolt Clearance Depth (in) (E)	Overall Length (in) (L)	Weight (lbs)
6	J5006MH	J5006M	25/64	21/32	5/16	1-11/16	2-1/8	0.10
7	J5007MH	J5007M	27/64	21/32	5/16	1-11/16	2-1/8	0.09
8	J5008MH	J5008M	15/32	21/32	5/16	1-15/16	2-1/8	0.10
9	J5009MH	J5009M	33/64	21/32	25/64	1-11/16	2-1/8	0.10
10	J5010MH	J5010M	37/64	21/32	25/64	1-11/16	2-1/8	0.11
11	J5011MH	J5011M	21/32	21/32	7/16	1-11/16	2-1/8	0.12
12	J5012MH	J5012M	45/64	45/64	33/64	1-1/2	2-1/8	0.14
13	J5013MH	J5013M	23/32	23/32	33/64	1-1/2	2-1/8	0.15
14	J5014MH	J5014M	25/32	25/32	19/32	1-1/2	2-1/8	0.16
15	J5015MH	J5015M	55/64	55/64	21/32	2-5/16	2-3/4	0.24
16	J5016MH	J5016M	55/64	55/64	21/32	2-5/16	2-3/4	0.24
17	J5017MH	J5017M	15/16	15/16	21/32	2-5/16	2-3/4	0.28
18	J5018MH	J5018M	15/16	15/16	21/32	2-5/16	2-3/4	0.28
19	J5019MH	J5019M	1-1/64	1-1/64	11/16	2-5/16	2-3/4	0.33
20	J5020MH	J5020M	1-5/64	1-5/64	11/16	2-5/16	2-3/4	0.35
21	J5021MH	J5021M	1-5/64	1-5/64	11/16	2-5/16	2-3/4	0.35
22	J5022MH	J5022M	1-11/64	1-11/64	11/16	2-5/16	2-3/4	0.46
23	J5023MH	J5023M	1-15/64	1-15/64	1-3/16	2-5/16	2-3/4	0.55
24	J5024MH	-	1-9/32	1-9/32	1-3/16	2-5/16	2-3/4	0.56
25	J5025MH	-	1-9/32	1-9/32	1-3/16	2-5/16	2-3/4	0.56
26	J5026MH	J5026M	1-9/32	1-9/32	1-3/16	2-5/16	2-3/4	0.65

6 6 POINT
8 8 POINT
12 12 POINT
SPL SPLINE
HEX HEX
FULL POLISH
SATIN
BLACK OXIDE
INSULATED